

527 CODIERSCHALTER FLACHE AUSFÜHRUNG LOW PROFILE ROTARY CODED SWITCHES

527

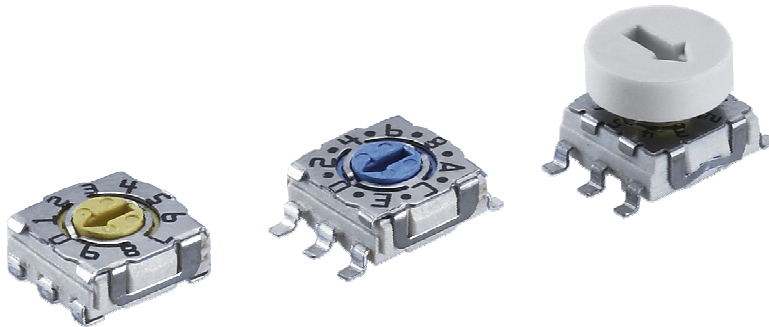

527

AUSFÜHRUNG

- + Miniatur-Drehcodierschalter mit BCD-, Hexa-, Gray- oder Komplementärkode
- + 8, 10 oder 16 Schaltstellungen
- + Vertikale Betätigung
- Optional: verschiedene Knopfvarianten

CONSTRUCTION

- + *Miniature rotary code switch with BCD hexa, gray or complementary code*
- + *8, 10 or 16 positions*
- + *Operated vertically*
- Optional: multiple button designs*

ANSCHLÜSSE

SMD- oder THT- Ausführung

PINING

SMD or THT design

ABMESSUNGEN

Vertikal: 7,2 x 7,1 x 2,7 mm

DIMENSIONS

Vertical: 7.2 x 7.1 x 2.7 mm

AUSFÜHRUNG CONSTRUCTION	Schaltweise Anschlußmaße Abmessungen	Breake before make (bbm) See drawing See drawing	Function Pitch Outline Dimensions
ISOLIERWERKSTOFFE INSULATION MATERIAL	Gehäuse Kontaktträger Betätiger	Stainless steel Thermoplastic-UL-94-V0 Thermoplastic-UL-94-V0	Housing Contact Body Actuator
KONTAKTWERKSTOFFE CONTACT MATERIAL	Festkontakte Schaltkontakte Lötanschlüsse	CuSn6 gal. Ni Au1 CuBe gal. Ni1 Au1 CuSn6 gal. Ni1 Sn4	Fixed Contacts Sliding Contacts Pins lead-free
ELEKTRISCHE DATEN ELECTRICAL DATA	Schaltspannung Schaltstrom Übergangswiderstand Isolierwiderstand	Max. 30 V Max. 100 mA < 100 mOhm > 100 MOhm	Switching Voltage Switching Current Contact Resistance Insulation Resistance
MECHANISCHE DATEN MECHANICAL DATA	Lebensdauer Betriebstemperatur Lagertemperatur Betätigungsmoment Dichtheit nach DIN 40050	see code chart -50 °C to +125 °C -55 °C to +135 °C 1.5 Ncm ± 0.3 Ncm IP67	Life Expectancy Operating Temperature Storage Temperature Operating Torque Process seal acc. DIN 40050
LÖTBEDINGUNGEN/ART SOLDERING TIME / CONDITIONS	SMD	acc. to IPC/JEDEC J-STD-020D Tab. 4-2 (max. peak temperature +260°)	SMD

Empfohlene Reflow Temperaturkurve
recommended reflow temperature profile

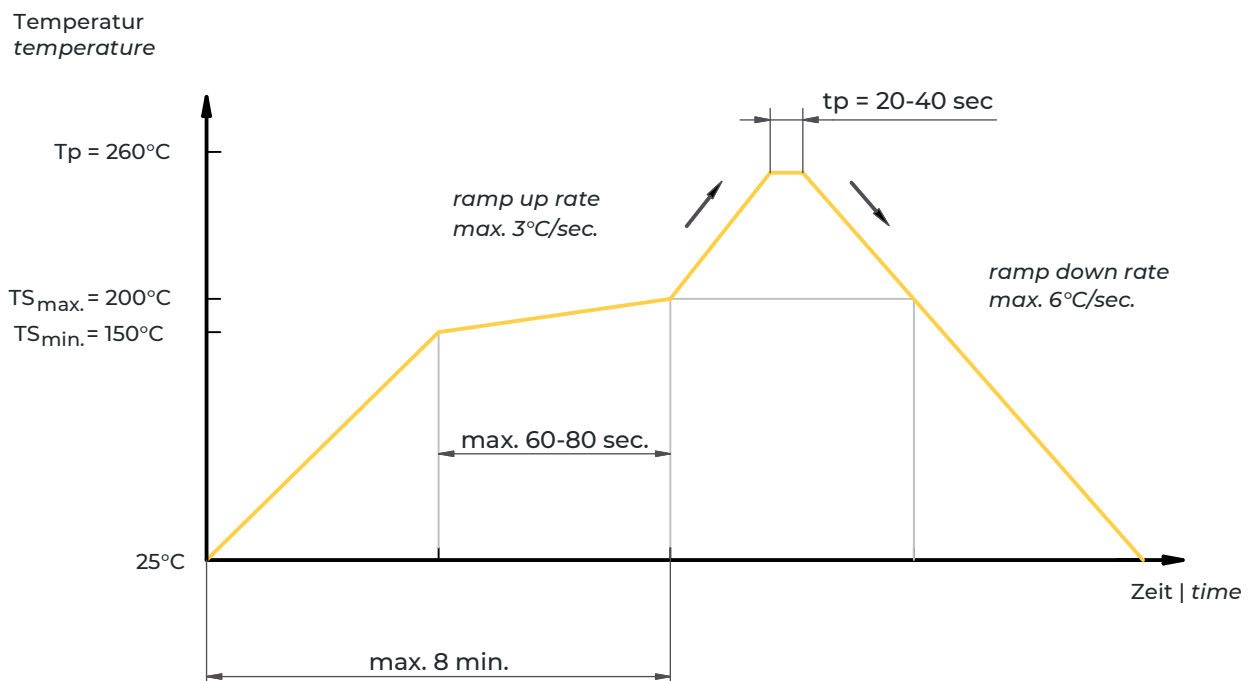

Pos. 6 SCHALTERAUSFÜHRUNG | SWITCH VERSION

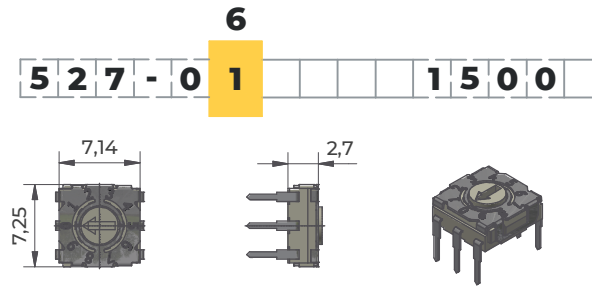

Pos. 7 KODIERUNG | CODE

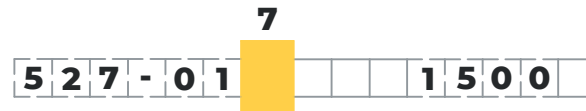

mit C verbunden
in connect with C

Kodierung code	Farbe colour	Positionen positions	Schaltpositionen actuator position	Lebensdauer life expectancy																																																																																						
				Wertigkeit terminal number (output)																																																																																						
1 BCD	gelb yellow	10	<table border="1"> <tr><td></td><td>0</td><td>1</td><td>2</td><td>3</td><td>4</td><td>5</td><td>6</td><td>7</td><td>8</td><td>9</td></tr> <tr><td>1</td><td></td><td></td><td></td><td></td><td></td><td></td><td></td><td></td><td></td><td></td></tr> <tr><td>2</td><td></td><td></td><td></td><td></td><td></td><td></td><td></td><td></td><td></td><td></td></tr> <tr><td>4</td><td></td><td></td><td></td><td></td><td></td><td></td><td></td><td></td><td></td><td></td></tr> <tr><td>8</td><td></td><td></td><td></td><td></td><td></td><td></td><td></td><td></td><td></td><td></td></tr> </table>		0	1	2	3	4	5	6	7	8	9	1											2											4											8											1200 Umdrehungen 1200 operations	12000 Schritte 12000 steps																														
					0	1	2	3	4	5	6	7	8	9																																																																												
				1																																																																																						
				2																																																																																						
4																																																																																										
8																																																																																										
2 BCD complement	rot red	10	<table border="1"> <tr><td></td><td>0</td><td>1</td><td>2</td><td>3</td><td>4</td><td>5</td><td>6</td><td>7</td><td>8</td><td>9</td></tr> <tr><td>1</td><td></td><td></td><td></td><td></td><td></td><td></td><td></td><td></td><td></td><td></td></tr> <tr><td>2</td><td></td><td></td><td></td><td></td><td></td><td></td><td></td><td></td><td></td><td></td></tr> <tr><td>4</td><td></td><td></td><td></td><td></td><td></td><td></td><td></td><td></td><td></td><td></td></tr> <tr><td>8</td><td></td><td></td><td></td><td></td><td></td><td></td><td></td><td></td><td></td><td></td></tr> </table>		0	1	2	3	4	5	6	7	8	9	1											2											4											8											1200 Umdrehungen 1200 operations	12000 Schritte 12000 steps																														
					0	1	2	3	4	5	6	7	8	9																																																																												
				1																																																																																						
				2																																																																																						
4																																																																																										
8																																																																																										
3 Hexadecimal	blau blue	16	<table border="1"> <tr><td></td><td>0</td><td>1</td><td>2</td><td>3</td><td>4</td><td>5</td><td>6</td><td>7</td><td>8</td><td>9</td><td>A</td><td>B</td><td>C</td><td>D</td><td>E</td><td>F</td></tr> <tr><td>1</td><td></td><td></td><td></td><td></td><td></td><td></td><td></td><td></td><td></td><td></td><td></td><td></td><td></td><td></td><td></td><td></td></tr> <tr><td>2</td><td></td><td></td><td></td><td></td><td></td><td></td><td></td><td></td><td></td><td></td><td></td><td></td><td></td><td></td><td></td><td></td></tr> <tr><td>4</td><td></td><td></td><td></td><td></td><td></td><td></td><td></td><td></td><td></td><td></td><td></td><td></td><td></td><td></td><td></td><td></td></tr> <tr><td>8</td><td></td><td></td><td></td><td></td><td></td><td></td><td></td><td></td><td></td><td></td><td></td><td></td><td></td><td></td><td></td><td></td></tr> </table>		0	1	2	3	4	5	6	7	8	9	A	B	C	D	E	F	1																	2																	4																	8																	400 Umdrehungen 400 operations	6400 Schritte 6400 steps
					0	1	2	3	4	5	6	7	8	9	A	B	C	D	E	F																																																																						
				1																																																																																						
				2																																																																																						
4																																																																																										
8																																																																																										
4 Hexadecimal complement	grün green	16	<table border="1"> <tr><td></td><td>0</td><td>1</td><td>2</td><td>3</td><td>4</td><td>5</td><td>6</td><td>7</td><td>8</td><td>9</td><td>A</td><td>B</td><td>C</td><td>D</td><td>E</td><td>F</td></tr> <tr><td>1</td><td></td><td></td><td></td><td></td><td></td><td></td><td></td><td></td><td></td><td></td><td></td><td></td><td></td><td></td><td></td><td></td></tr> <tr><td>2</td><td></td><td></td><td></td><td></td><td></td><td></td><td></td><td></td><td></td><td></td><td></td><td></td><td></td><td></td><td></td><td></td></tr> <tr><td>4</td><td></td><td></td><td></td><td></td><td></td><td></td><td></td><td></td><td></td><td></td><td></td><td></td><td></td><td></td><td></td><td></td></tr> <tr><td>8</td><td></td><td></td><td></td><td></td><td></td><td></td><td></td><td></td><td></td><td></td><td></td><td></td><td></td><td></td><td></td><td></td></tr> </table>		0	1	2	3	4	5	6	7	8	9	A	B	C	D	E	F	1																	2																	4																	8																	400 Umdrehungen 400 operations	6400 Schritte 6400 steps
					0	1	2	3	4	5	6	7	8	9	A	B	C	D	E	F																																																																						
				1																																																																																						
				2																																																																																						
4																																																																																										
8																																																																																										
5 Graycode	beige beige	10	<table border="1"> <tr><td></td><td>0</td><td>1</td><td>2</td><td>3</td><td>4</td><td>5</td><td>6</td><td>7</td><td>8</td><td>9</td></tr> <tr><td>1</td><td></td><td></td><td></td><td></td><td></td><td></td><td></td><td></td><td></td><td></td></tr> <tr><td>2</td><td></td><td></td><td></td><td></td><td></td><td></td><td></td><td></td><td></td><td></td></tr> <tr><td>4</td><td></td><td></td><td></td><td></td><td></td><td></td><td></td><td></td><td></td><td></td></tr> <tr><td>8</td><td></td><td></td><td></td><td></td><td></td><td></td><td></td><td></td><td></td><td></td></tr> </table>		0	1	2	3	4	5	6	7	8	9	1											2											4											8											1200 Umdrehungen 1200 operations	12000 Schritte 12000 steps																														
					0	1	2	3	4	5	6	7	8	9																																																																												
				1																																																																																						
				2																																																																																						
4																																																																																										
8																																																																																										
8 BCD	schwarz black	8	<table border="1"> <tr><td></td><td>0</td><td>1</td><td>2</td><td>3</td><td>4</td><td>5</td><td>6</td><td>7</td></tr> <tr><td>1</td><td></td><td></td><td></td><td></td><td></td><td></td><td></td><td></td></tr> <tr><td>2</td><td></td><td></td><td></td><td></td><td></td><td></td><td></td><td></td></tr> <tr><td>4</td><td></td><td></td><td></td><td></td><td></td><td></td><td></td><td></td></tr> <tr><td>8</td><td></td><td></td><td></td><td></td><td></td><td></td><td></td><td></td></tr> </table>		0	1	2	3	4	5	6	7	1									2									4									8									1200 Umdrehungen 1200 operations	9600 Schritte 9600 steps																																								
					0	1	2	3	4	5	6	7																																																																														
				1																																																																																						
				2																																																																																						
4																																																																																										
8																																																																																										

527

Pos. 8 | 9 ACHS ODER KNOPFAUSFÜHRUNG | SHAFT OR KNOB VERSION

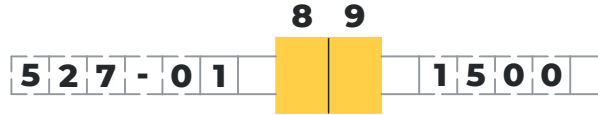

01

ohne Achse / Knopf
without knob / shaft

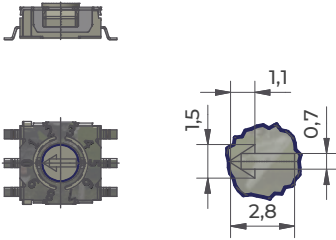

07

Knopf mit Schlitz unbedruckt
knob with slot without printing

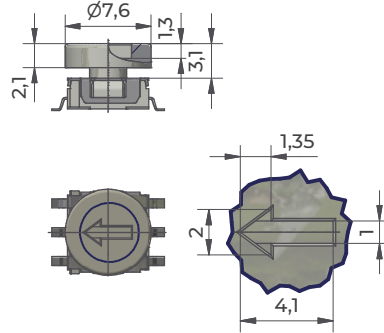

08

Knopf mit Schlitz bedruckt
knob with slot with printing

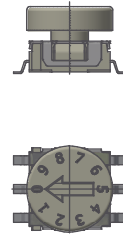

Schlitz 1,6 ±0,05mm tief / Knopffarbe grau
slot 1,6 +0,05mm deep / knob colour gray

527

Pos. 10 ANSCHLUSSART | TERMINAL DESIGN



1

THT Pin
THT pin

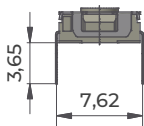

Leiterplattenlochbild (Bauteilseite)
drilling matrix (component side)

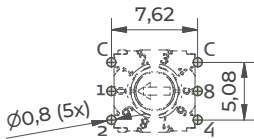

2

SMD: Gull-wing
SMD: Gull-wing

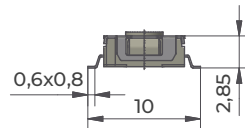

Löt-Pad-Anordnung
SMD soldering pad

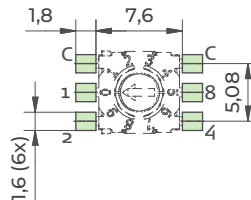

3

SMD: J-hook
SMD: J-hook

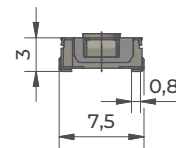

Löt-Pad-Anordnung
SMD soldering pad

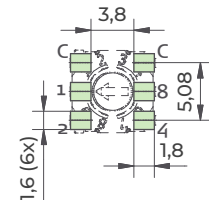

WERKSTOFFE MATERIALS	Blistergurt	PET or PS	Embossed tape
	Abdeckband	PET	Reel
	Zugkraft	min. 10 N	Embossed tape pull strength
ABDECKBAND TOP COVER TAPE	Abzugswinkel	165° - 180°	Peel - off angle
	Abzugsgeschwindigkeit	300 mm / min.	Peel - off speed
	Abzugskraft	0.1 - 0.7 N	Peel - off force

Pos. 15 VERPACKUNG | PACKAGING



1 Palette | palette

2 Gurt | embossed tape

Blistergurtabmessungen | embossed tape dimensions

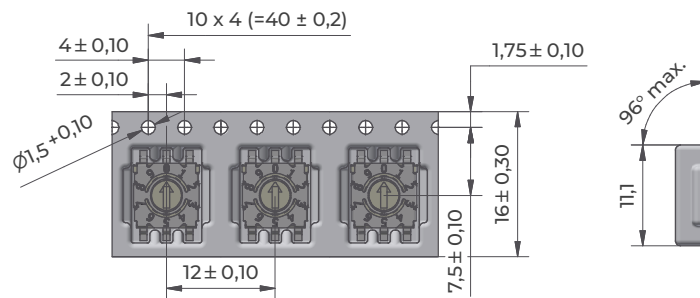
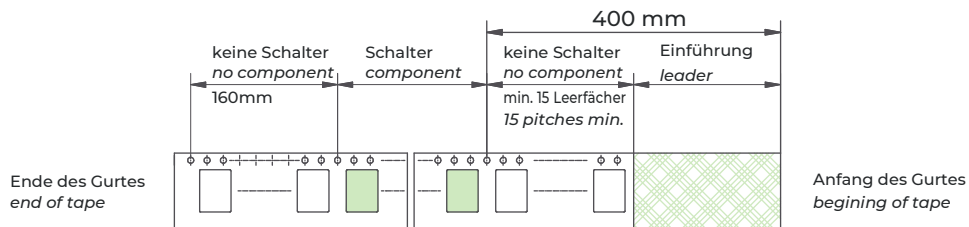

SMD Gull-Wing / SMD J-hook

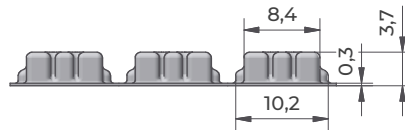

SMD Gull-Wing / SMD J-hook

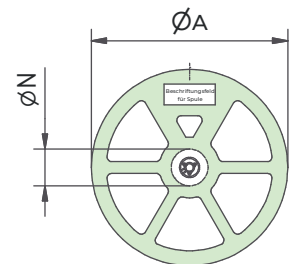
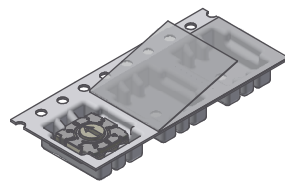
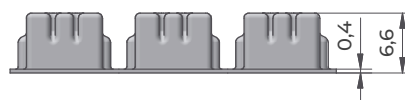

Spulenabmessungen
reel dimensions

	max. Stückzahl number of pieces	Maß "A" dimension "A"	Maß "N" dimension "N"
ohne Knopf 01 without knob 01	1700	330 mm	60 mm
mit Knopf 07 / 08 with knob 07 / 08	900	330 mm	60 mm

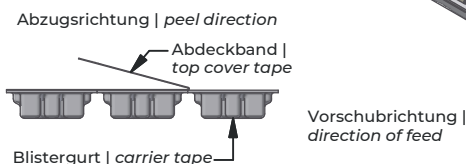

Anschrift | Address

Firma: <i>Company:</i>	_____	Datum: <i>Date:</i>	_____
Adresse: <i>Address:</i>	_____	Tel.: <i>Phone:</i>	_____
Name: <i>Name:</i>	_____	Fax: <i>Fax:</i>	_____
Kundenr.: <i>Customer No.:</i>	_____	E-Mail: <i>E-Mail:</i>	_____

Bestellschlüssel | ordering code

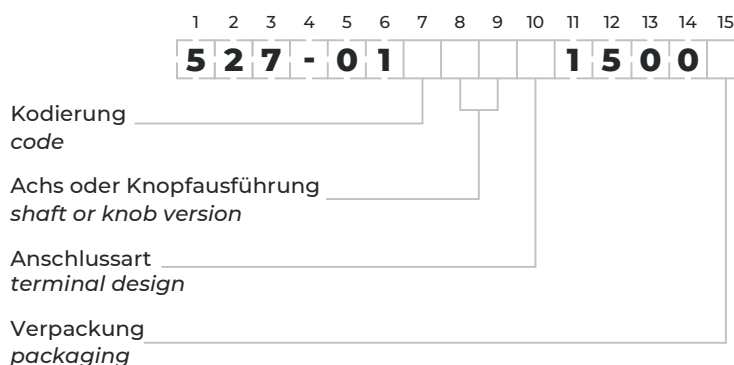

Muster und 3D-Daten | Samples and 3D Data

Bitte nutzen Sie die nebenstehenden Links und QR-Codes, um Ihre individuellen Muster und 3D-Daten anzufordern.

www.hopt-schuler.com



Please use the links and QR-codes beside to require your specific samples and 3D Data.

sales@hopt-schuler.com

